

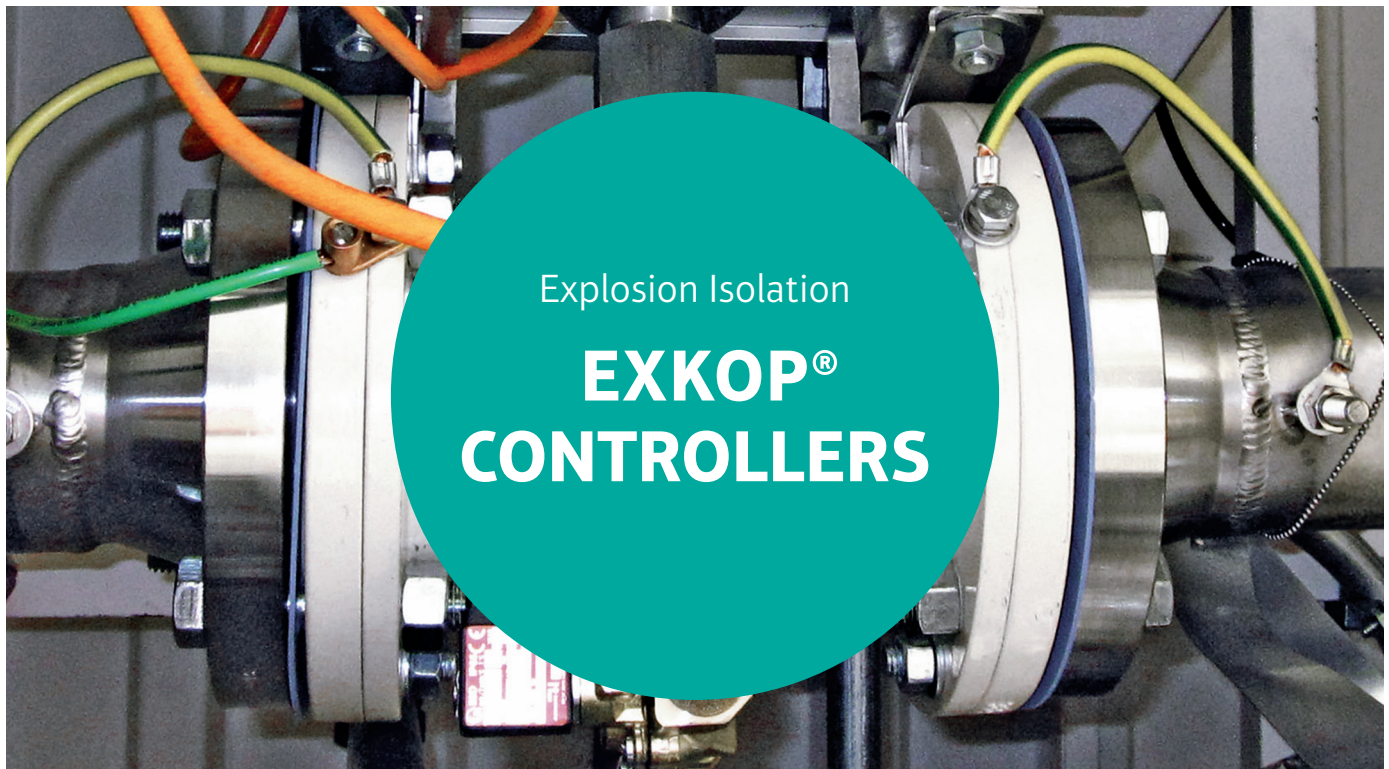

Safety is for life.™

PRODUCT INFORMATION



EXKOP® CONTROLLERS FOR VARIOUS ISOLATION SYSTEMS

Applications

In the case of an explosion, the EXKOP® controllers receive a trigger signal (e.g. from the signalling unit of the Q-Rohr®, an explosion vent, from a pressure sensor or IR-Flame detector) and activate the connected isolation systems which prevents an explosion from propagating.



ATEX
EC type examination
certificate no.
FSA 04 ATEX 1537 X
FSA 15 ATEX 1659 X
DNV 25 ATEX 68993X

Your advantages

| EXKOP® TriCon | EXKOP® Express |
|---|---|
| <ul style="list-style-type: none">• Fail-safe, compact control centre for the QV II Quenchvalve.• Developed for simplified commissioning of small applications. | <ul style="list-style-type: none">• One controller for all isolation systems (Quench valves QV II and QV III, Q-Bic™ as well as slide valves RSV and REDEX® Slide).• Self-monitoring safety electronics with operating data storage up to 100.000 events.• Compatible with REMBE® iQ.• System status and clear messages reported immediately via the touch panel (optional).• Online remote access possible (optional). |

Made
in
Germany



iQ Safety Cockpit™

You can find detailed information and contact details for enquiries relating to EXKOP® controllers at www.rembe.de.
Give us a call on: T +49 2961 7405-0 or contact us via email: info@rembe.de





Safety is for life.™

PRODUCT INFORMATION

EXKOP® TriCon

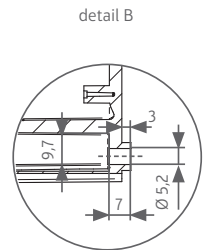
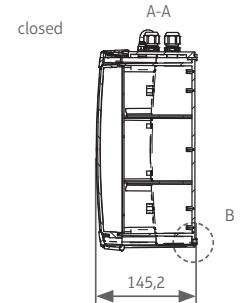
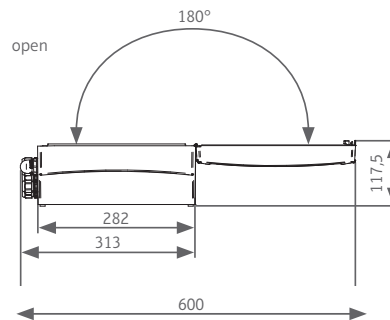
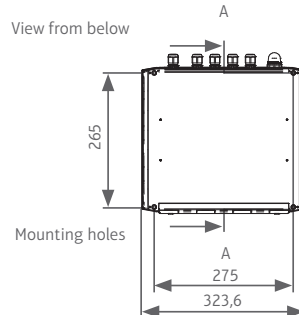
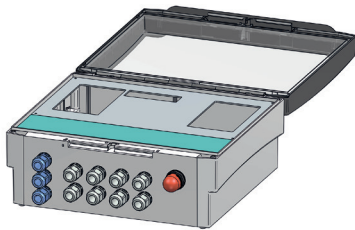

Technical data*

| | EXKOP® TriCon | EXKOP® Express |
|---|---|---|
| EC type examination certificate | FSA 15 ATEX 1660 X | GEX 19 ATEX 1003X |
| Supply voltage | 110 V AC/60 Hz – 230 V AC/50 Hz | 110 V AC/60 Hz – 230 V AC/50 Hz** |
| Max. no. of connectable detectors (lines) | 3 | 2 to 36 (x3) |
| Isolation systems | QV II | QV II, QV III, Q-Bic™, RSV, REDEX® Slide |
| Max. no. of connectable isolation units | 3 | Depends on the special application |
| Power consumption | ca. 150 W | Depends on the special size |
| Potential-free relay contacts | 4 (max. 250 V, 6A) | from 4 to 64 |
| Wire cross-section (fine wire with ferrule) | 0,5 – 0,75 mm² | 0,5 – 1,5 mm² |
| Ambient temperature | 0 – 50 °C (32–122 °F) | 0 – 50 °C |
| Protection type | IP 65 | IP 54 |
| ATEX category | Zone-free | Zone-free |
| Housing material | Polycarbonate housing with lockable transparent front | Sheet steel housing with powder-coated front |
| Dimensions (W × H × D) | ca. 324 × 313 × 145 mm | Depending on the number of detectors and decoupling systems |
| Weight | ca. 4 kg | Depending on the number of detectors and decoupling systems |
| Remote access | - | optional |
| Touch Panel | - | available |

*Our specialists will be pleased to assist you in finding a solution that matches your specific operating conditions.

**Depends on the size of the controller.



EXKOP® TriCon



EXKOP® Express

Consulting. Engineering. Products. Service.

REMBE® GmbH Safety+Control

Gallbergweg 21 | 59929 Brilon, Germany | T +49 2961 7405-0 | F +49 2961 50714
info@rembe.de | www.rembe.de